

LEGEND	
	DROPPED KERBS, LAID FLUSH FOR PEDESTRIAN CROSSING POINTS, WITH 400mm x 400mm x 65mm 'BUFF' COLOURED P.C.C. TACTILE PAVING
	DROPPED GRANITE KERBS, LAID FLUSH FOR VEHICLE CROSSOVER (REUSE EXISTING WHERE POSSIBLE)
	EXISTING GRANITE KERBS RE-USED (100mm UPSTAND)
	NEW GRANITE KERBS (100mm UPSTAND) TO BS EN 1343.
	NEW SIGN POST
	985mm HIGH x 190mm Ø GLASDON MANCHESTER STYLE STAINLESS STEEL BOLLARD, WITH 300mm ³ CONCRETE BASE, TO WSCC SPECIFICATIONS (SEE TYPICAL DETAILS)
	800mm x 980mm MARSHALL'S OLLERTON FIN STAINLESS STEEL CYCLE STANDS, WITH 300mm ³ CONCRETE BASE(S)
	EXISTING GULLEY WITH CONNECTION
	PROPOSED GULLEY AND CONNECTION (SEE TYPICAL DETAILS)
	MARSHALL'S KEY CHANNEL DRAINAGE BLOCK, BRINDLE COLOUR, TO BS EN 1338:2003 (SEE TYPICAL DETAILS)
	500mm WIDE CARRIAGEWAY TIE-IN (SEE TYPICAL DETAILS)
	NEW FOOTWAY CONSTRUCTION: 200mm x 100mm x 60mm MARSHALL'S KEYBLOCK PAVING WITH CHAMFERED EDGE (BRINDLE COLOUR), LAID IN HERRINGBONE PATTERN (SEE TYPICAL DETAILS)
	TAKE UP AND RELAY EXISTING FOOTWAY PAVING: LAID IN HERRINGBONE PATTERN ON VARYING THICKNESS OF SHARP SAND. FOOTWAY TO BE REPROFILED AS SHOWN ON 'PROPOSED VERTICAL ALIGNMENT - CROSS SECTIONS PLAN' (TSP/HSPC/P2431/05).
	BREAKOUT EXISTING FOOTWAY PAVING AND LAY NEW 200mm x 100mm x 60mm MARSHALL'S KEYBLOCK PAVING WITH CHAMFERED EDGE (BRINDLE COLOUR), LAID IN HERRINGBONE PATTERN (SEE TYPICAL DETAILS)

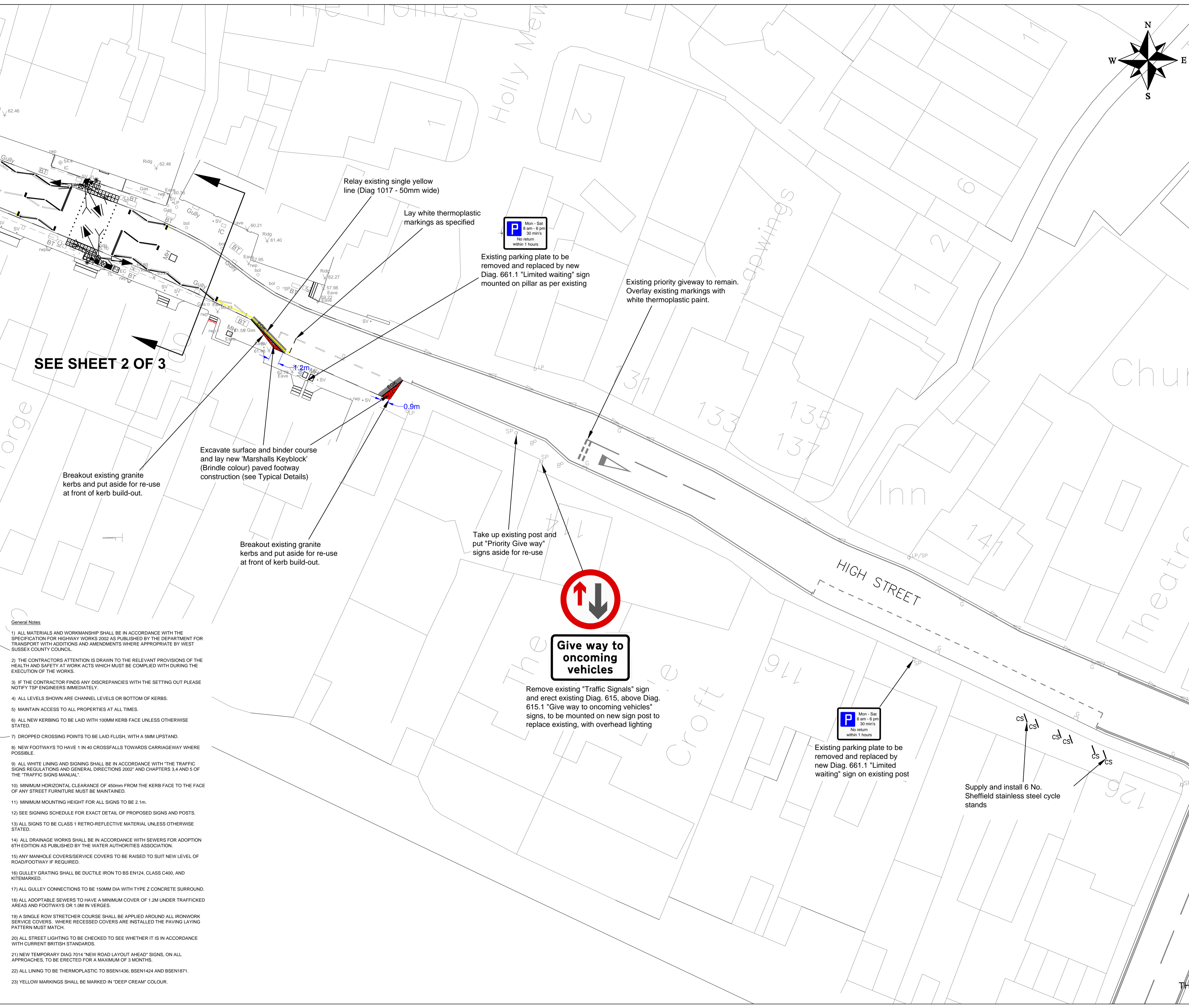

SEE SHEET 2 OF 3

- General Notes**
- 1) ALL MATERIALS AND WORKMANSHIP SHALL BE IN ACCORDANCE WITH THE SPECIFICATION FOR HIGHWAY WORKS 2002 AS PUBLISHED BY THE DEPARTMENT FOR TRANSPORT WITH ADDITIONS AND AMENDMENTS WHERE APPROPRIATE BY WEST SUSSEX COUNTY COUNCIL.
 - 2) THE CONTRACTORS ATTENTION IS DRAWN TO THE RELEVANT PROVISIONS OF THE HEALTH AND SAFETY AT WORK ACTS WHICH MUST BE COMPLIED WITH DURING THE EXECUTION OF THE WORKS.
 - 3) IF THE CONTRACTOR FINDS ANY DISCREPANCIES WITH THE SETTING OUT PLEASE NOTIFY TSP ENGINEERS IMMEDIATELY.
 - 4) ALL LEVELS SHOWN ARE CHANNEL LEVELS OR BOTTOM OF KERBS.
 - 5) MAINTAIN ACCESS TO ALL PROPERTIES AT ALL TIMES.
 - 6) ALL NEW KERBING TO BE LAID WITH 100MM KERB FACE UNLESS OTHERWISE STATED.
 - 7) DROPPED CROSSING POINTS TO BE LAID FLUSH, WITH A 5MM UPSTAND.
 - 8) NEW FOOTWAYS TO HAVE 1 IN 40 CROSSFALLS TOWARDS CARRIAGEWAY WHERE POSSIBLE.
 - 9) ALL WHITE LINING AND SIGNING SHALL BE IN ACCORDANCE WITH 'THE TRAFFIC SIGNS REGULATIONS AND GENERAL DIRECTIONS 2002' AND CHAPTERS 3.4 AND 5 OF 'THE TRAFFIC SIGNS MANUAL'.
 - 10) MINIMUM HORIZONTAL CLEARANCE OF 450mm FROM THE KERB FACE TO THE FACE OF ANY STREET FURNITURE MUST BE MAINTAINED.
 - 11) MINIMUM MOUNTING HEIGHT FOR ALL SIGNS TO BE 2.1m.
 - 12) SEE SIGNING SCHEDULE FOR EXACT DETAIL OF PROPOSED SIGNS AND POSTS.
 - 13) ALL SIGNS TO BE CLASS 1 RETRO-REFLECTIVE MATERIAL UNLESS OTHERWISE STATED.
 - 14) ALL DRAINAGE WORKS SHALL BE IN ACCORDANCE WITH SEWERS FOR ADOPTION 6TH EDITION AS PUBLISHED BY THE WATER AUTHORITIES ASSOCIATION.
 - 15) ANY MANHOLE COVERS/SERVICE COVERS TO BE RAISED TO SUIT NEW LEVEL OF ROAD/FOOTWAY IF REQUIRED.
 - 16) GULLEY GRATING SHALL BE DUCTILE IRON TO BS EN124, CLASS C400, AND KITEMARKED.
 - 17) ALL GULLEY CONNECTIONS TO BE 150MM DIA WITH TYPE Z CONCRETE SURROUND.
 - 18) ALL ADOPTABLE SEWERS TO HAVE A MINIMUM COVER OF 1.2M UNDER TRAFFICKED AREAS AND FOOTWAYS OR 1.0M IN VERGES.
 - 19) A SINGLE ROW STRETCHER COURSE SHALL BE APPLIED AROUND ALL IRONWORK SERVICE COVERS. WHERE RECESSED COVERS ARE INSTALLED THE PAVING LAYING PATTERN MUST MATCH.
 - 20) ALL STREET LIGHTING TO BE CHECKED TO SEE WHETHER IT IS IN ACCORDANCE WITH CURRENT BRITISH STANDARDS.
 - 21) NEW TEMPORARY DIAG 7014 'NEW ROAD LAYOUT AHEAD' SIGNS, ON ALL APPROACHES, TO BE ERECTED FOR A MAXIMUM OF 3 MONTHS.
 - 22) ALL LINING TO BE THERMOPLASTIC TO BSEN1436, BSEN1424 AND BSEN1871.
 - 23) YELLOW MARKINGS SHALL BE MARKED IN 'DEEP CREAM' COLOUR.

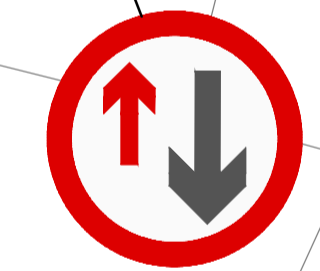

Give way to oncoming vehicles

Remove existing "Traffic Signals" sign and erect existing Diag. 615, above Diag. 615.1 "Give way to oncoming vehicles" signs, to be mounted on new sign post to replace existing, with overhead lighting



Existing parking plate to be removed and replaced by new Diag. 661.1 "Limited waiting" sign on existing post

Supply and install 6 No. Sheffield stainless steel cycle stands

REV	DESCRIPTION	DATE
J	NOTES ADDED TO PUFFIN ZIG-ZAGS	3/11/14
H	MINOR AMENDMENTS TO PUFFIN ZIG-ZAGS	30/10/14
G	PUFFIN CROSSING ADDED	29/10/14
F	S278 COMMENTS ADDED	07/10/14
E	KEY AMENDED	05/08/14
D	AMENDMENTS FOLLOWING MEETING WITH CLIENT & WSCC	02/07/14
C	STAGE 2 RSA COMMENTS INCORPORATED	27/02/14
B	HSPC COMMENTS INCORPORATED	1/11/13
A	WSCC COMMENTS INCORPORATED	13/9/13

Stilwell
PARTNERSHIP
 SAFETY, TRAFFIC & HIGHWAY
 ENGINEERING CONSULTANTS
 SATELLIET HOUSE, 2 NEXUS PARK
 ASH VALE, SURREY, GU12 5QE
 Tel: 01276 700400, Fax: 01252 544 934
 E-Mail: info@stilwell-ltd.co.uk
 Web: www.stilwell-ltd.co.uk

PROJECT: HIGH STREET, HURSTPIERPOINT - IMPROVEMENT SCHEME

TITLE: GENERAL LAYOUT PLAN - SHEET 3 OF 3

SCALE: 1:200 @ A1 DRAWN: JB

DATE: MAY 2013 CHECKED:

DWG No: TSP/HSPC/P2431/03 J

THIS IS A CONTROLLED DOCUMENT